

Instructions for use Probe insert Cone (149292)

Attention

The probe insert (cone) 149292 is compatible with 3D probe analog Garant, 3D probe digital and 3D probe analog.

Assembly

- 1 Screw in probe insert and tighten firmly with pin wrench.
- 2 Insert the probe into the chuck of the lathe.
- 3 Check the concentricity of the stylus and adjust it if necessary using the 2 lateral adjustment screws.

Probing

- 4 Probing (X/Y axis) (set tool to spindle center)
Approach the tapered probe insert in X or Y direction with the tool until the pointer is at 0. The tool is now positioned exactly to the spindle center.

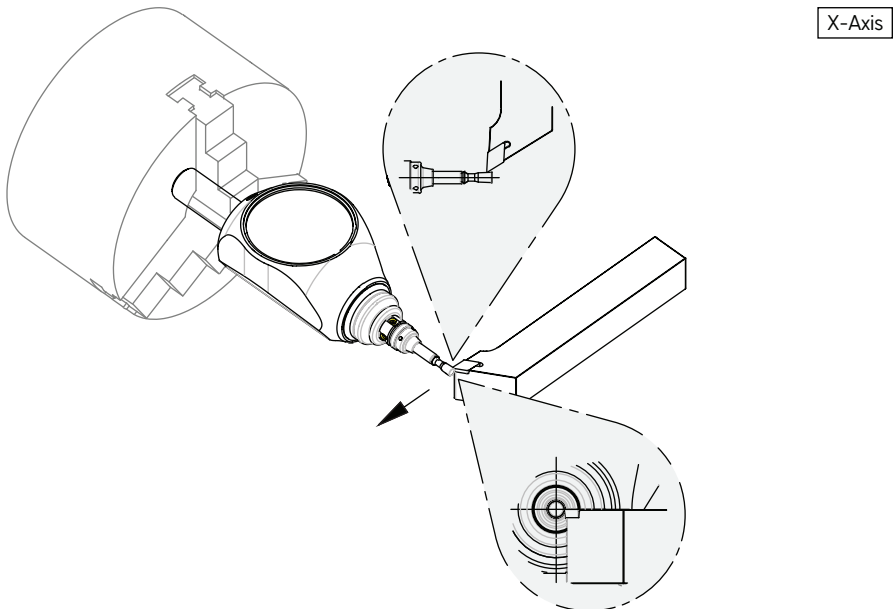

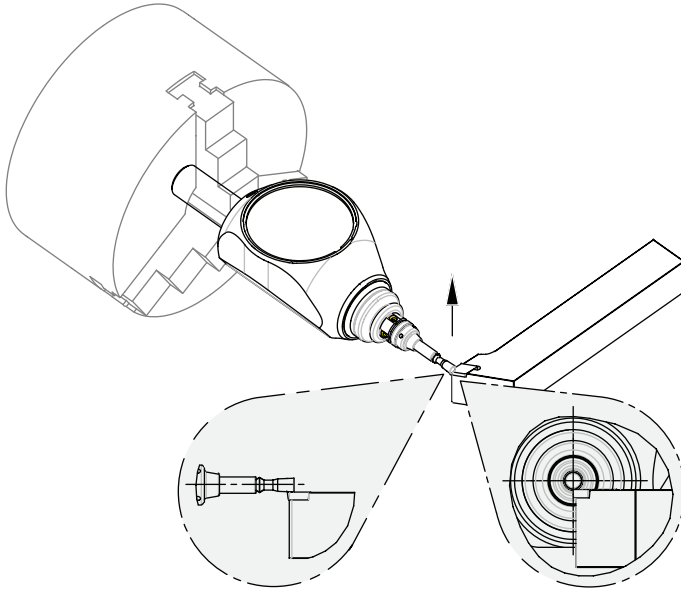

5 Probing (Z axis) (Determine tool length)

Using a tool that has already been measured, first determine the reference length of the probe to the machine. To do this, move the tool to the face of the stylus until the pointer is at 0.

Then each tool length can be determined in the same way.

